

GENERAL NOTES

1. The client is happy to provide a contribution of £70k to cover the cost for undertaking the white lining and TRO amendments.
2. The client is happy to provide a contribution of £70k to cover the cost for undertaking the white lining and TRO amendments.
3. The client is happy to provide a contribution of £70k to cover the cost for undertaking the white lining and TRO amendments.
4. The client is happy to provide a contribution of £70k to cover the cost for undertaking the white lining and TRO amendments.
5. The client is happy to provide a contribution of £70k to cover the cost for undertaking the white lining and TRO amendments.
6. The client is happy to provide a contribution of £70k to cover the cost for undertaking the white lining and TRO amendments.
7. The client is happy to provide a contribution of £70k to cover the cost for undertaking the white lining and TRO amendments.
8. The client is happy to provide a contribution of £70k to cover the cost for undertaking the white lining and TRO amendments.
9. The client is happy to provide a contribution of £70k to cover the cost for undertaking the white lining and TRO amendments.
10. The client is happy to provide a contribution of £70k to cover the cost for undertaking the white lining and TRO amendments.
11. The client is happy to provide a contribution of £70k to cover the cost for undertaking the white lining and TRO amendments.
12. The client is happy to provide a contribution of £70k to cover the cost for undertaking the white lining and TRO amendments.
13. The client is happy to provide a contribution of £70k to cover the cost for undertaking the white lining and TRO amendments.
14. The client is happy to provide a contribution of £70k to cover the cost for undertaking the white lining and TRO amendments.
15. The client is happy to provide a contribution of £70k to cover the cost for undertaking the white lining and TRO amendments.
16. The client is happy to provide a contribution of £70k to cover the cost for undertaking the white lining and TRO amendments.
17. The client is happy to provide a contribution of £70k to cover the cost for undertaking the white lining and TRO amendments.

DESIGNER RISK ASSESSMENT

1. The client is happy to provide a contribution of £70k to cover the cost for undertaking the white lining and TRO amendments.

Details for new Echelon parking to be developed with Highways Dept as a planning approval condition.

The client is happy to provide a contribution of £70k to cover the cost for undertaking the white lining and TRO amendments.

The exact users of the parking will need to be determined when the details are drawn up.

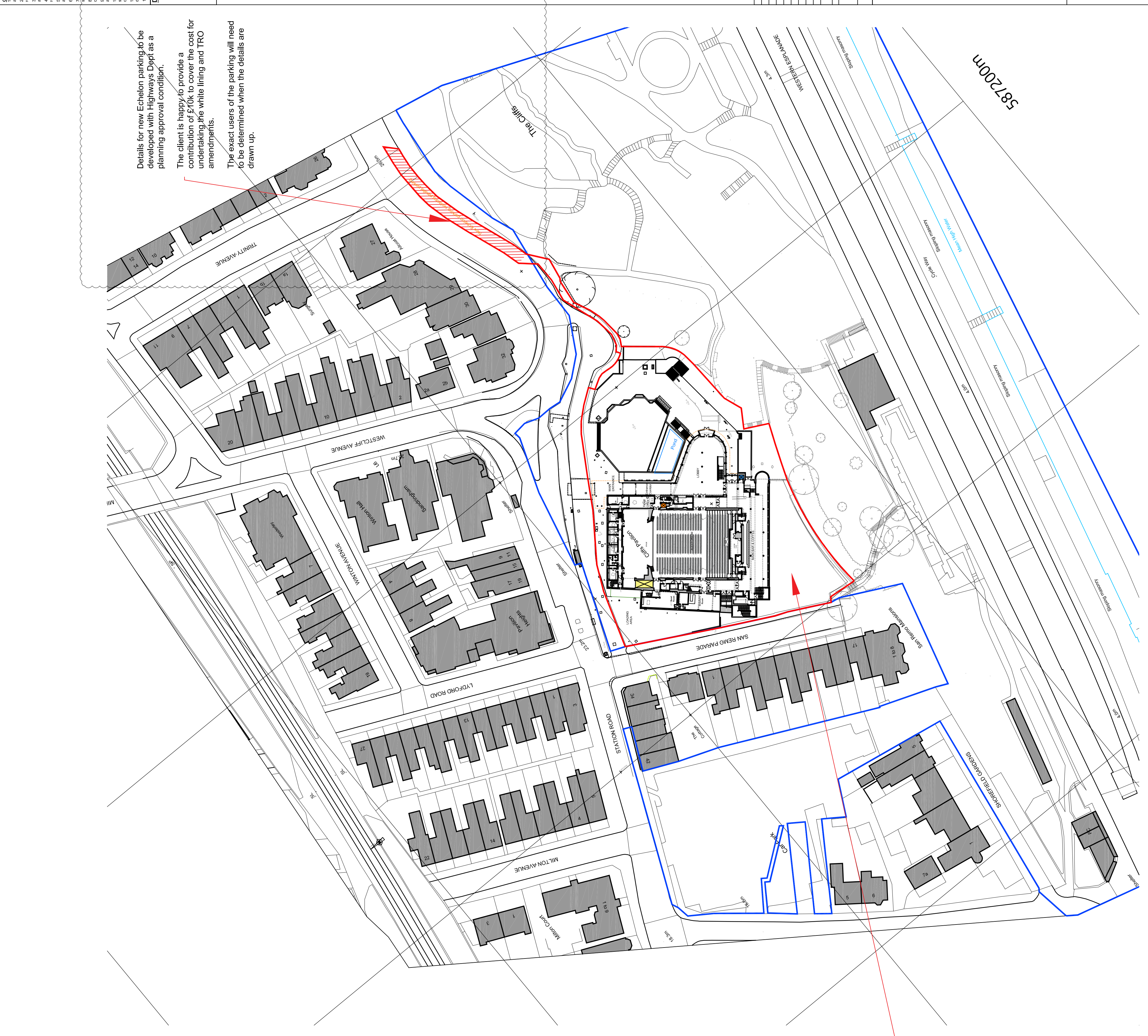

1 EXISTING LOCATION PLAN

1:1250000

- SITE CONSTRAINTS BOUNDARY
- COUNCIL OWNERSHIP BOUNDARY
- AMENDED STREET CAR PARKING BOUNDARY

ON SITE CAR PARKING
The existing car parking area will be reviewed and a design developed to ensure that disabled parking is catered as well as providing Electric Vehicle Charging points.

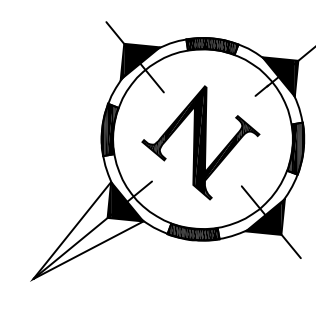

2 EXISTING SITE PLAN

1:500000

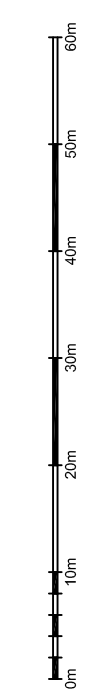

© Crown Copyright and database rights 2018 OS 100019980

B	06/10/21	Red outline added to connect street parking to
A	05/10/21	Street Parking and Parking notes added

- INFORMATION ONLY
APPLICATION FOR LOCAL AUTHORITY
- TENDER
 - CONSTRUCTION
 - AS BUILT

PROJECT: Cliff's Pavilion, Southend

TITLE: EXISTING SITE & LOCATION PLANS

DRAWN	DATE	SCALE	CHECKED
	June 21	Varies@A0	
PROJECT	NUMBER	REVISION	
01711-B	01-00	B	

DESIGNLSM

+44 (0)1273 820 033
hello@designlsm.com
designlsm.com

Office 11, Level 6,
Tower Point, 44 North Road,
Brighton, BN1 1YR